

DIVERSIFIED AIR SYSTEMS, INC.

MAXFLO-DD™

downdraft table

- *250 FPM Downdraft Velocity, Sit Down Option*
- *Helps Meet or Exceed OSHA Standards*
- *Recirculates Clean Air, Eliminating the Need for Expensive Make-up Air*



- *Cartridge Filtration with Reverse Jet Pulse Cleaning System*
- *Quiet Operation, Low Air to Cloth Ratio, Easy to Maintain*
- *Ships Fully Assembled, Plug & Play Ready to Use*

Superior technology generating substantial operating savings

TYPICAL APPLICATIONS FOR THE MAXFLO-DD DOWNDRAFT TABLE

• Welding • Buffing • Deburring • Cutting • Grinding • Mixing • Sanding

OUTSTANDING MAXFLO-DD FEATURES



**Made in USA
2 YEAR WARRANTY**

Call today: 800-264-8958

OUTSTANDING MAXFLO-DD FEATURES



Filter access door



Cartridge filter access door opened showing filter locking handle



External dust pan opened



Steel bar grate



Magnetic starter with auto pulse controls

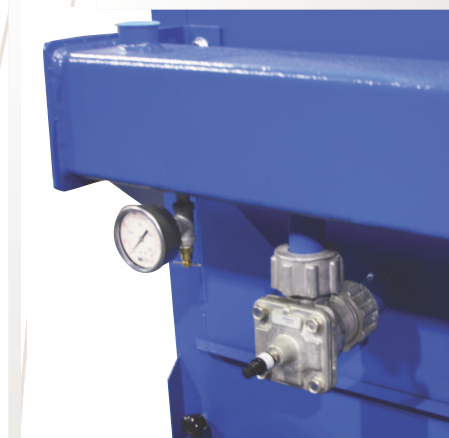

Manual pulse button and air pressure gauge

OUTSTANDING MAXFLO FEATURES



Dual backdraft table



Single backdraft table



*DD-22 with optional
fume arm*

OPTIONS

- Side shields and top panel
- Aluminum or fiberglass bar grating
- Automatic pulse cleaning systems
- 3 inch castor wheels
- HEPA after filter module
- Metal mesh prefilters
- Magnehelic pressure gauge
- Fume arm (DD-22 only)
- Silencer
- Dust tight fluorescent light
- Custom sizes
- Spun bond polyester media

Call today: 800-264-8958

OUTSTANDING MAXFLO-DD FEATURES

HEAVY DUTY 14 GAUGE STEEL CABINET FINISHED WITH A DARK BLUE CHEMICAL RESISTANT POLYURETHANE PAINT, MANUALLY ACTIVATED REVERSE JET PULSE, 24" X 21" TABLE AREA WITH STEEL FLAT BAR GRATE, AND A BUILT IN MOTOR/BLOWER SYSTEM WITH A 200 FPM DOWNDRAFT VELOCITY.

CHART 1

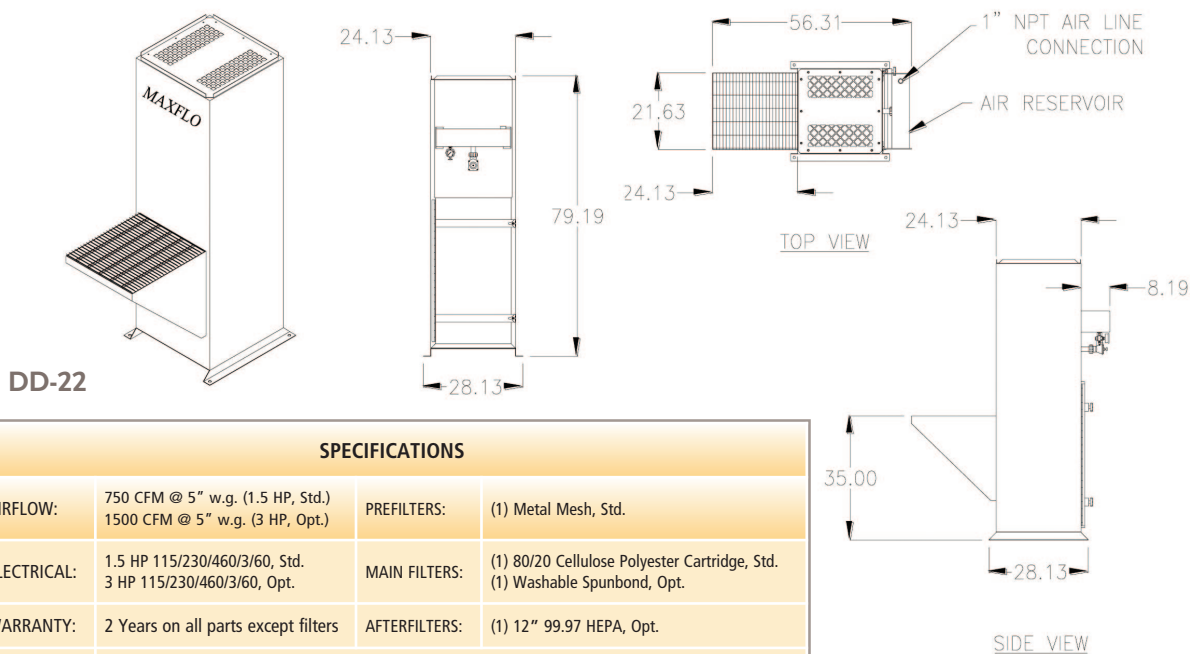

HEAVY DUTY 11 AND 14 GAUGE STEEL CABINET FINISHED WITH A DARK BLUE CHEMICAL RESISTANT POLYURETHANE PAINT, MANUALLY ACTIVATED REVERSE JET PULSE, 2" X 3" TABLE AREA WITH STEEL FLAT BAR GRATE, AND A BUILT IN MOTOR/BLOWER SYSTEM WITH A 250 FPM DOWNDRAFT VELOCITY.

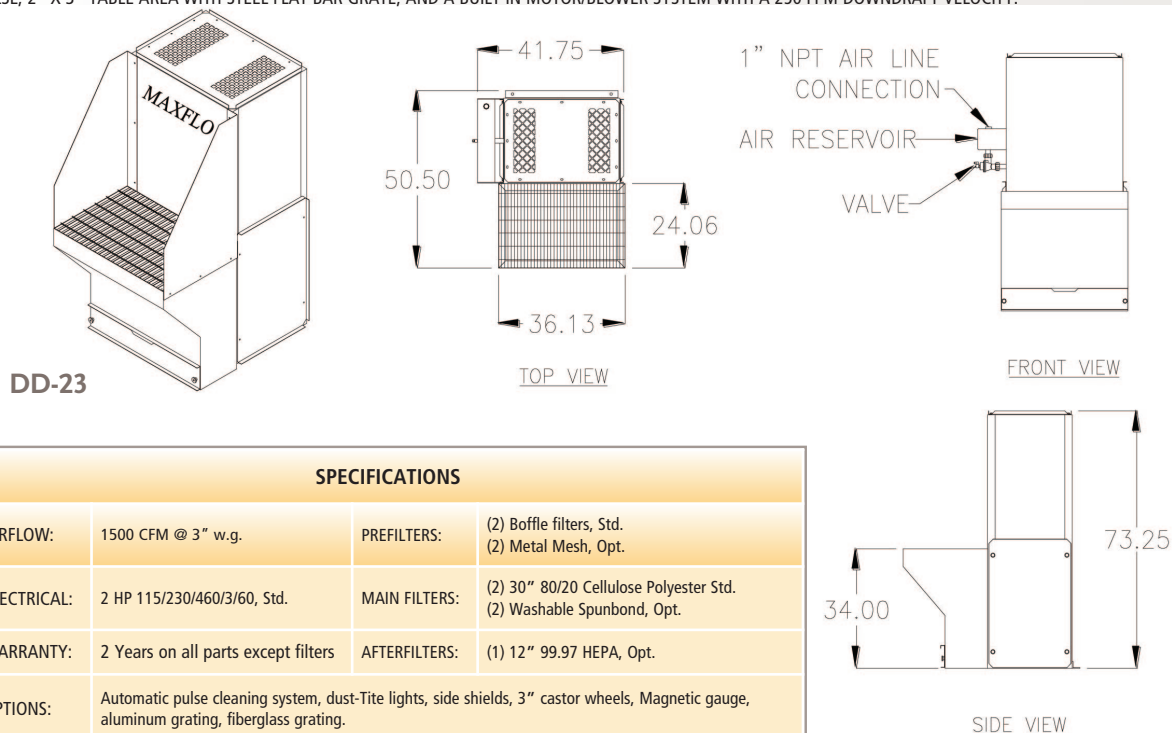

HEAVY DUTY 11 AND 14 GAUGE STEEL CABINET FINISHED WITH A DARK BLUE CHEMICAL RESISTANT POLYURETHANE PAINT, MANUALLY ACTIVATED REVERSE JET PULSE, 3" X 4" TABLE AREA WITH STEEL FLAT BAR GRATE, AND A BUILT IN MOTOR/BLOWER SYSTEM WITH A 250 FPM DOWNDRAFT VELOCITY.

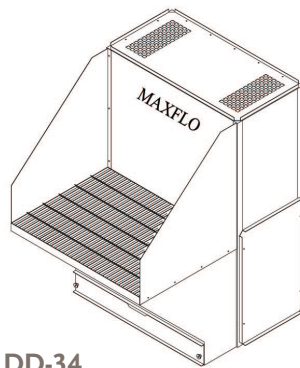

DD-34

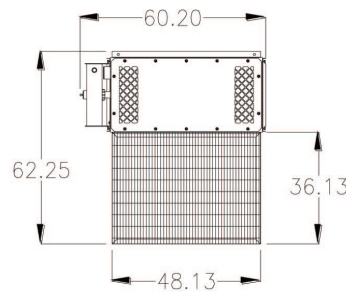

TOP VIEW

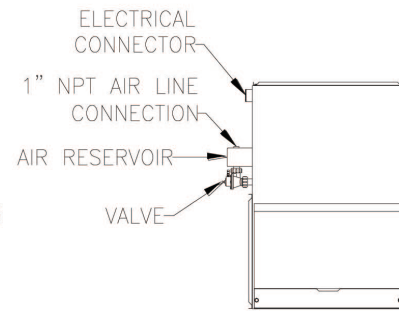

FRONT VIEW

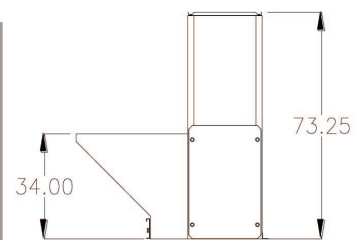

SIDE VIEW

SPECIFICATIONS

AIRFLOW:	3000 CFM @ 3" w.g.	PREFILTERS:	(3) Baffle filters, Std. (3) Metal Mesh, Opt.
ELECTRICAL:	5 HP 230/460/3/60, Std.	MAIN FILTERS:	(3) 30" 80/20 Cellulose Polyester Std. (3) Washable Spunbond, Opt.
WARRANTY:	2 Years on all parts except filters	AFTERFILTERS:	(2) 12" 99.97 HEPA, Opt.
OPTIONS:	Automatic pulse cleaning system, dust-Tite lights, side shields, 3" castor wheels, Magnetic gauge, aluminum grating, fiberglass grating.		

HEAVY DUTY 11 AND 14 GAUGE STEEL CABINET FINISHED WITH A DARK BLUE CHEMICAL RESISTANT POLYURETHANE PAINT, MANUALLY ACTIVATED REVERSE JET PULSE, 3" X 6" TABLE AREA WITH STEEL FLAT BAR GRATE, AND A BUILT IN MOTOR/BLOWER SYSTEM WITH A 250 FPM DOWNDRAFT VELOCITY.

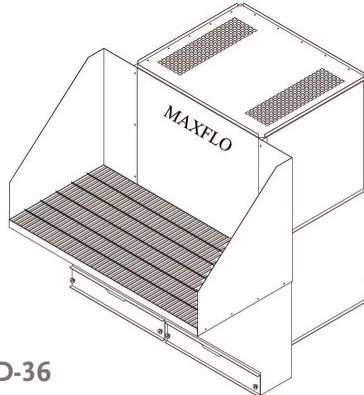

DD-36

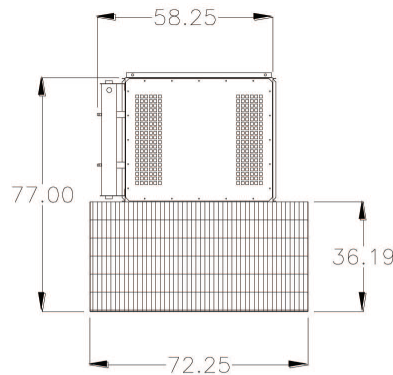

TOP VIEW

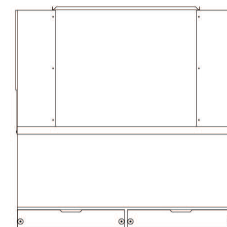

FRONT VIEW

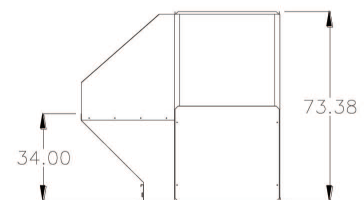

SIDE VIEW

SPECIFICATIONS

AIRFLOW:	4500 CFM @ 3" w.g.	PREFILTERS:	(4) Baffle filters, Std. (4) Metal Mesh, Opt.
ELECTRICAL:	7.5 HP 230/460/3/60, Std.	MAIN FILTERS:	(6) 30" 80/20 Cellulose Polyester Std. (6) Washable Spunbond, Opt.
WARRANTY:	2 Years on all parts except filters	AFTERFILTERS:	(2) 12" 99.97 HEPA, Opt.
OPTIONS:	Automatic pulse cleaning system, dust-Tite light, side shields, 4" castor wheels, Magnetic gauge, aluminum grating, fiberglass grating.		

Diversified Air Systems, Inc.

10801 Electron Drive, Louisville, Kentucky 40299

Toll free: (800) 264-8958

Tel.: (502) 267-0333 • Fax: (502) 267-4241

Website: www.diversair.com • email: info@diversair.com

DD Series Downdraft Table Dust Collector

The DD Series Dust Collector is a self contained up flow system with vertically positioned filters which eliminates particulate re-entrainment and improves filter life. Our venturi assist design optimizes reverse jet pulse cleaning, improves contaminant release and filter life. Units designed for continuous operation and for a wide variety of applications.

Specifications & Options

	DD-23, DD-34 & DD-36
Construction	11 ga./14 ga. Carbon Steel Welded Construction
Paint	Powder Coated Signal Blue
Base Unit Includes	Table, Collector, Blower & Dust Tray
Cleaning System Compressed Air	Manual Reverse Jet Pulse Cleaning 1" Valves
Pulse Controls	Optional Mag Gage & Single Station Pulse Timer
Self Contained Unit Motors	2HP/5HP & 7.5HP 208/230/460v/3ph/60hz
Backward Inclined Blowers	1,500 CFM, 3,000 CFM & 4,500 CFM @ 3.0" w.g.
Motor Starters	Manual Magnetic NEMA 1
Surface Capture Velocity	250 FPM Face Velocity with Even Distribution
Table Work Surface	Steel Bar Grate & Optional Fiberglass or Aluminum
Portable Unit	3" Castor Wheel Kits with Outrigger
Primary Filter	2 ea./4 ea./6 ea, @ 30" x 12.75" Cartridge Filter
Filter Media	500 sq. ft./750 sq. ft./1000 sq. ft., 80/20 Blend
Media Efficiency	99.5% @ 0.5 Micron
Media Options	Washable Spun Bond, Metal Mesh & Fire Retardant
Sound Rating	74 dBA @ 5'/76 dBA @ 5'/78 dBA @ 5'
Weight	850 lbs/1250 lbs/1650 lbs with Dust Tray
Additional Options	Side Walls, HEPA Afterfilters & Light Kits

Note: Specifications listed above may be modified to suit application. contact D.A.S. or representative for information.

Diversified Air Systems, Inc.

10801 Electron Drive, Louisville, Kentucky 40299

Toll free: **(800) 264-8958**

Tel.: **(502) 267-0333** • Fax: **(502) 267-4241**

Website: www.diversair.com • email: info@diversair.com